

iSWAB-Microbiome Universal Instructions For Use

iSWAB-Microbiome sample collection vial for oral swab, nasal swab, or saliva samples

REF ISM-T-1200, ISM-T-1200-R

Read ALL steps before collecting samples!

Intended use: For the collection of microbial DNA and RNA from any biological samples using saliva or swab(s)

Contents: The collection tube contains stabilizing liquid. Swabs and saliva funnel may be provided separately or packaged with the collection tube in a kit format.

Storage and Stability

Pre-collection: 18 months from date of manufacture between 15-30° C

Transport temperature, post-collection: 15-30° C

Sample stability and storage, post-collection: 21 days for microbial RNA and 40 days for microbial DNA at 15-30° C; if longer storage time is required, collected samples can be stored at -20 to -80° C indefinitely.

Additional information available at www.mawidna.com

Warnings and precautions: If the stabilizing liquid touches your skin or eyes, rinse the area with tap water. The small cap from the tube may be a choking hazard. For oral and nasal sample use only. See product SDS at www.mawidna.com

Preparation for use: Before sample collection, verify preferred method of collection with your processing lab

- Note: It is recommended not to eat, drink, or smoke for 30 minutes before collecting your sample
- Do not touch swab tips or allow contact with any other object.
- For swab collection, use either 1 or 2 swabs depending on the test protocol
- Tap the tube gently 2-3 times before collection

1

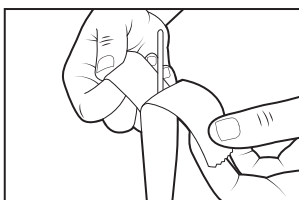

***If using saliva collection skip to step number 7**

Place vial standing up on flat surface. Peel open bags containing swabs and remove a swab. Unscrew vial cap prior to collection.

2

Collect a single nasal and/or throat swab sample according to established procedures.

3

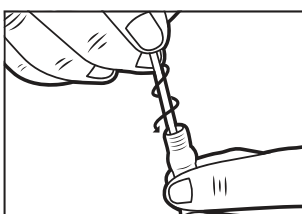

Pick up vial and hold steady in one hand. Slowly twist swab into iSWAB vial with a corkscrew motion. There will be resistance, but push swab all the way to the bottom of tube.

4

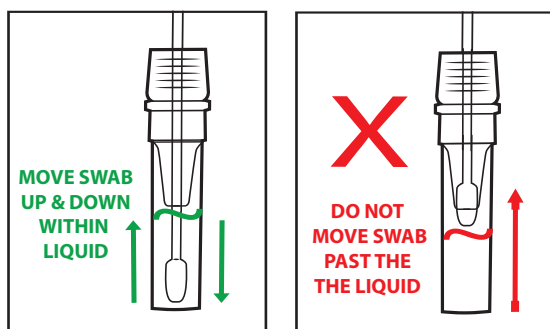

Hold vial steady and move swab up and down rapidly inside the tube 10-15 times without moving the swab out of the liquid.

iSWAB-Microbiome Universal Instructions For Use

iSWAB-Microbiome sample collection vial for oral swab, nasal swab, or saliva samples

REF ISM-T-1200, ISM-T-1200-R

5

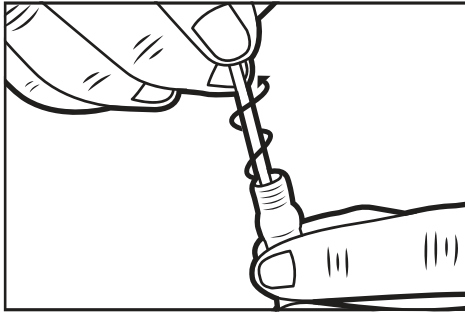

At this point remove and discard the swab. Hold vial firmly and remove swab by slowly twisting out with a corkscrew motion.

6

If necessary, collect second sample according to established procedures and repeat steps 3-5.

***Ignore this step if only using swabs for collection**

7











For Saliva Collection:

1. Remove cap from tube and place on a clean surface.
2. Place funnel into the tube so that it is resting upright as shown in the picture
3. Stimulate saliva production in your mouth
4. Spit 1 or 2 times directly into the funnel
5. Allow several seconds for all saliva to pass through the funnel into the tube.
6. Remove funnel and replace cap securely
7. Gently shake the vial 5-10x to allow mixing

8

After all required samples have been taken, replace cap tightly. Make sure all swabs or funnel have been properly disposed of.

Label Legend:

- | | |
|--|---|
|  Collect sample by, use by |  Storage temperature |
|  Manufacturer |  Consult package insert |
|  Lot number |  Caution, consult instructions for use |
|  Part number |  Instructions for use must be read before collection |
| |  Research Use Only |

Patent ([www.mawidna.com/legal notices](http://www.mawidna.com/legal%20notices))

© 2020 Mawi DNA Technologies, LLC